

SUBJECT PROPERTY

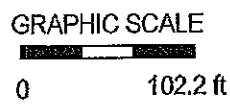

ASRC Barrow Hotel

Applicant: Paul Kari, ASRC SKW Eskimos, Inc.
 COE File No.: POA-2011-693
 Waterway: Chukchi Sea
 Purpose: Construct ASRC Barrow Hotel
 Sec. 32 T. 23N R. 18W M. Umiat
 Lat.: 71°17'52.24" Long.: 156°46'16.36"
 Sheet 1 of 6 Revised Date 01/09/2013

TRAVIS/PETERSON ENVIRONMENTAL CONSULTING, INC.
 319 2ND STREET
 FAIRBANKS, ALASKA 99701

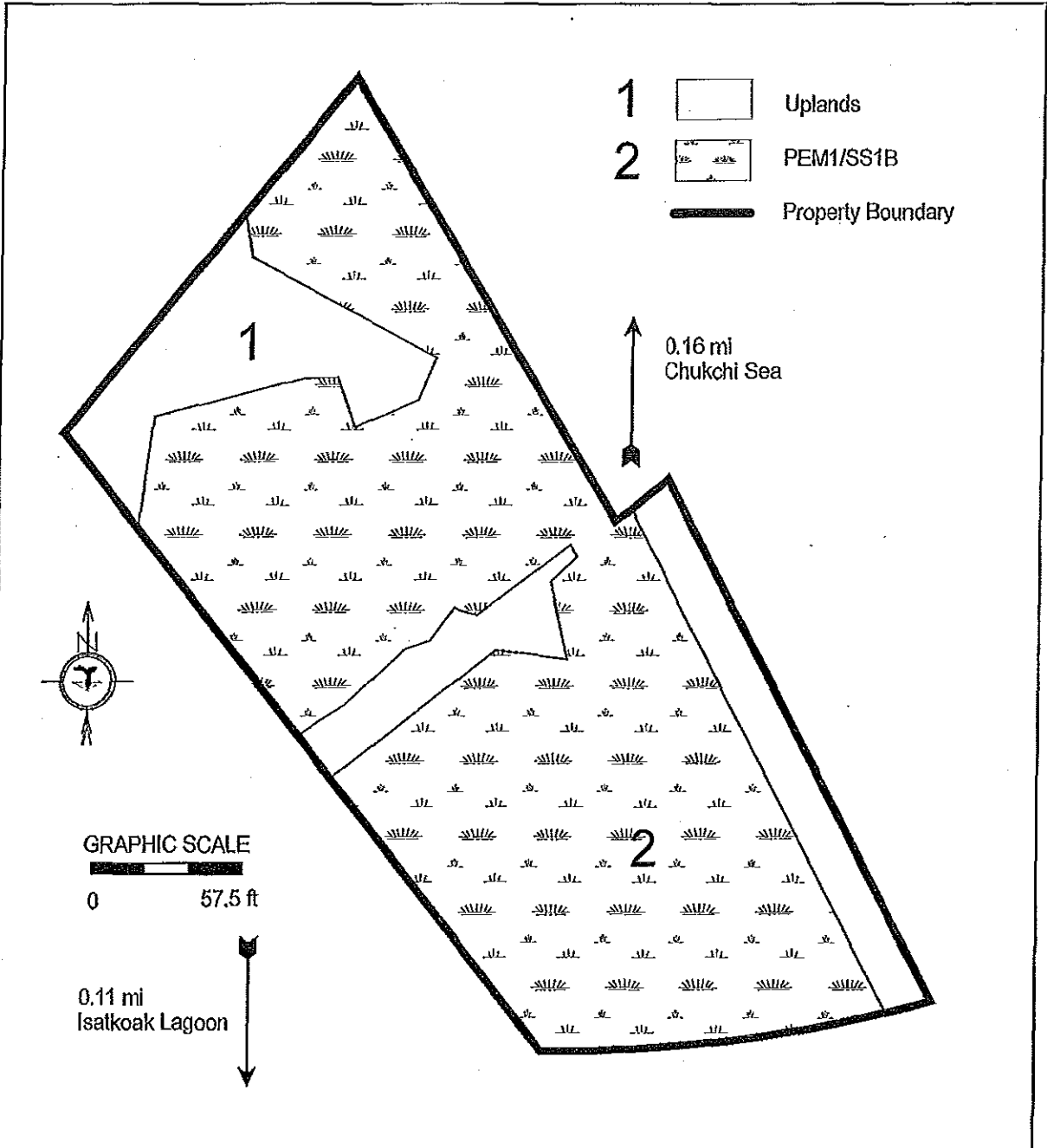

- 1 Uplands
- 2 PEM1/SS1B
- Property Boundary

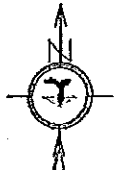

GRAPHIC SCALE
 0 57.5 ft

0.11 mi
 Isatkoak Lagoon

0.16 mi
 Chukchi Sea

ASRC Barrow Hotel

Applicant: Paul Kari, ASRC SKW Eskimos, Inc.
 COE File No.: POA-2011-693
 Waterway: Chukchi Sea
 Purpose: Construct ASRC Barrow Hotel
 Sec. 32 T. 23N R. 18W M. Umiat
 Lat.: 71°17'52.24" Long.: 156°46'16.36"
 Sheet 2 of 6 Revised Date 01/09/2013

Note
 No RPD or TNW were identified on the project site.

TRAVIS PETERSON ENVIRONMENTAL CONSULTING, INC.
 329 2ND STREET
 FAIRBANKS, ALASKA 99701

PROJECT NO: 1084-28	FILE: S:\Projects\108428\Figures\Sheet 2 of 6.SKF	DATE: 01/09/2013	SCALE: AS SHOWN
---------------------	---	------------------	-----------------

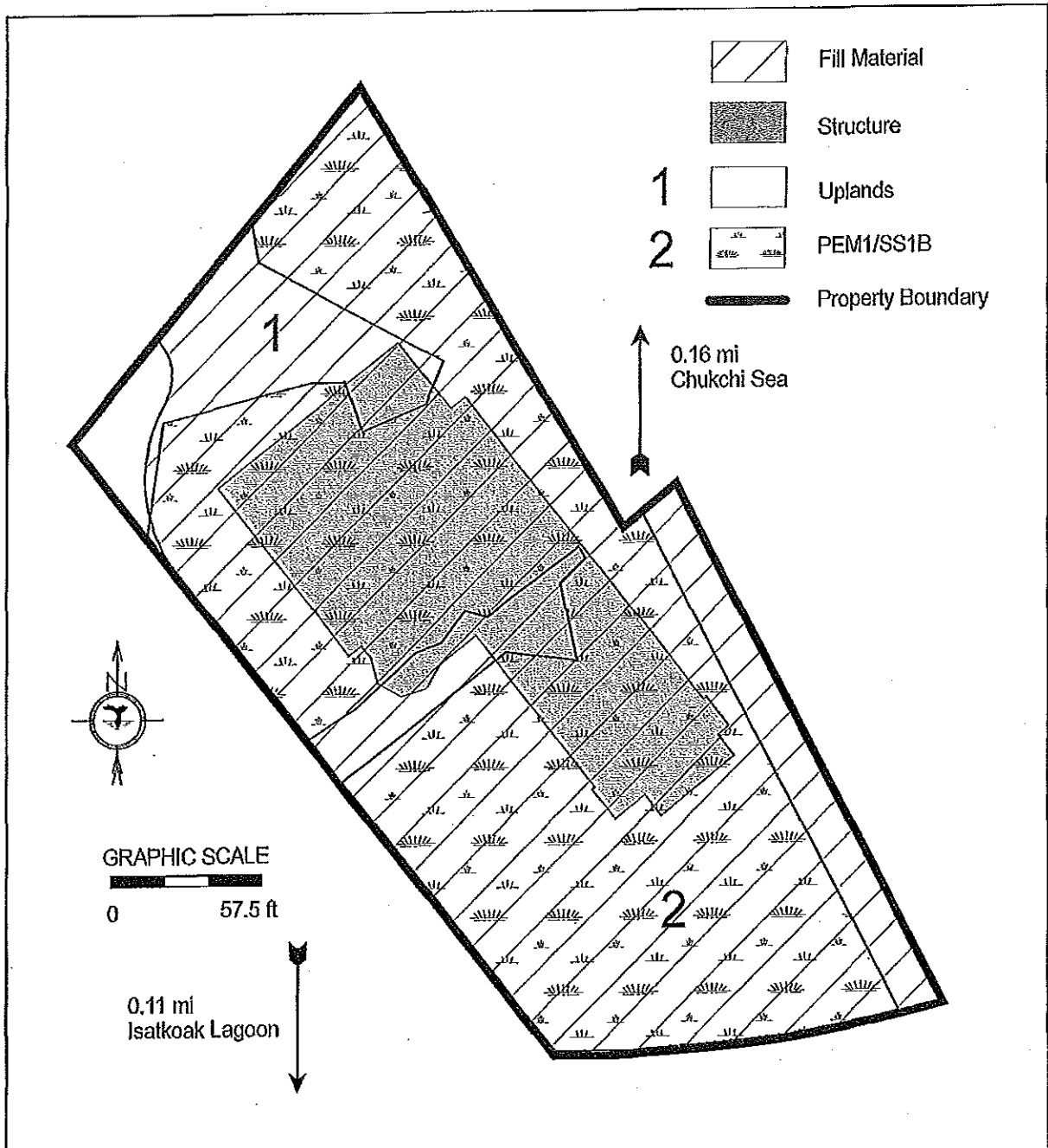

- Notes**
1. All fill material will be sands and gravels, with a range of 5-15% passing the #200 sieve.
 2. No RPD or TNW were identified on the project site.

TRAVIS/PETERSON ENVIRONMENTAL CONSULTING, INC.
 329 2ND STREET
 FAIRBANKS, ALASKA 99701

ASRC Barrow Hotel
 Applicant: Paul Kari, ASRC SKW Eskimos, Inc.
 COE File No.: POA-
 Waterway: Chukchi Sea
 Purpose: Construct ASRC Barrow Hotel
 Sec. 32 T. 23N R. 18W M. Umiat
 Lat.: 71°17'52.24" Long.: 156°46'16.36"
 Sheet 3 of 6 Revised Date 01/09/2013

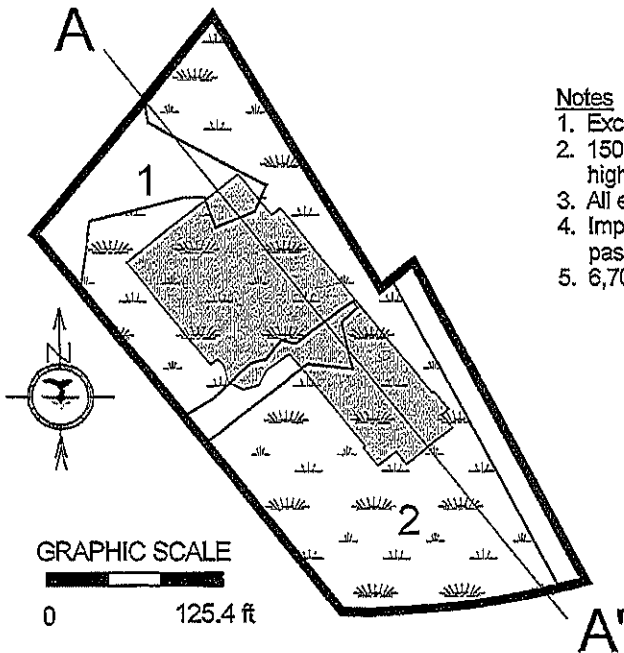
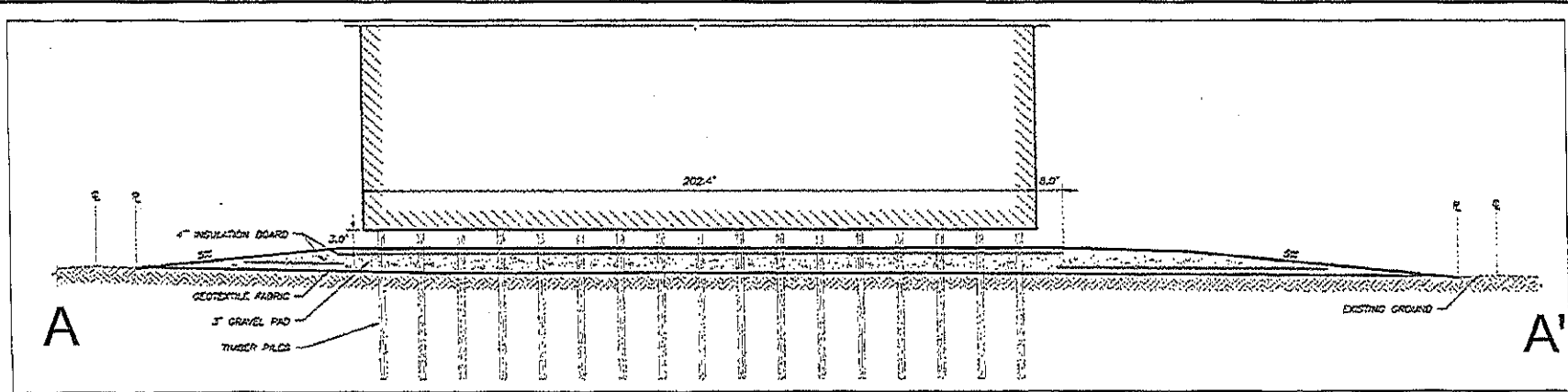

Notes



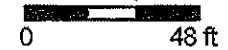

1. Excavation will be limited to underground utility work and pole holes.
2. 150 cubic yards of native materials (including organic overburden and high silts) will be removed.
3. All excavation will take place in winter conditions.
4. Imported fill material will be sands and gravels, with a range of 5-15% passing #200 sieve.
5. 6,700 cubic yards of fill material will be used on the project area.

Horizontal Graphic Scale

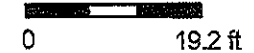

Vertical Graphic Scale



-  Structure
-  Uplands
-  PEM1/SS1B
-  Property Boundary

ASRC Barrow Hotel

Applicant: Paul Kari, ASRC SKW Eskimos, Inc.
 COE File No.: POA-2011-693
 Waterway: Chukchi Sea
 Purpose: Construct ASRC Barrow Hotel
 Sec. 32 T. 23N R. 18W M. Umiaf
 Lat.: 71°17'52.24" Long.: 156°46'16.36"
 Sheet 4 of 6 Revised Date 01/09/2013

TRAVIS/PETERSON ENVIRONMENTAL CONSULTING, INC.
 329 2ND STREET
 FAIRBANKS, ALASKA 99701

PROJECT NO: 1084-28

FILE: S:\Projects\108428\Figures\Sheet 4 of 6.SKF

DATE: 01/09/2013

SCALE: AS SHOWN

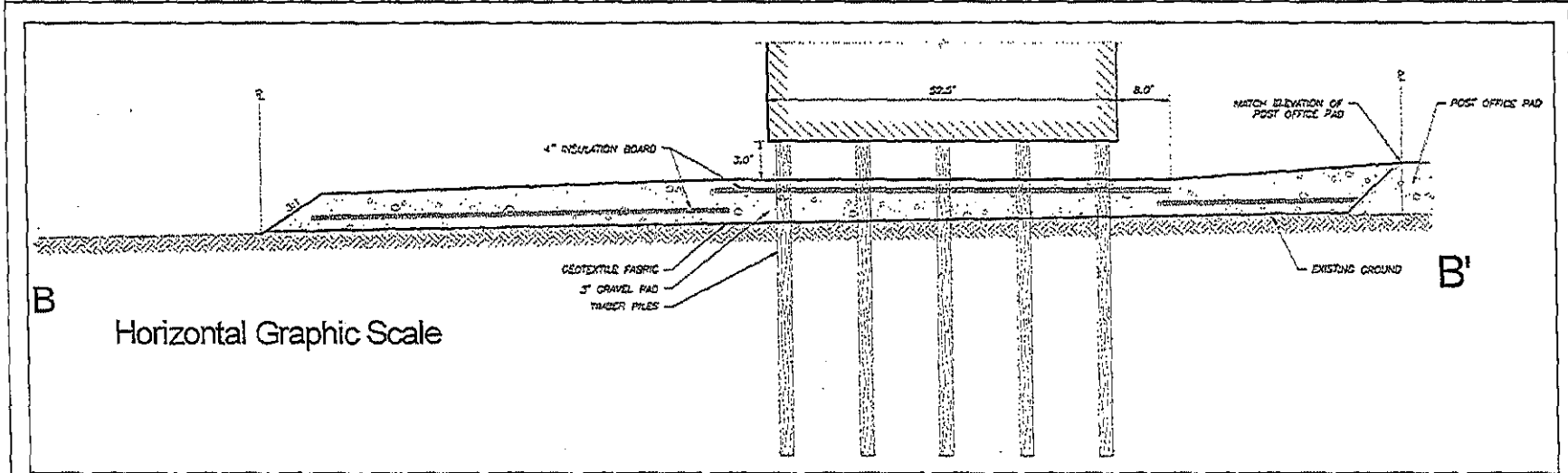

Horizontal Graphic Scale

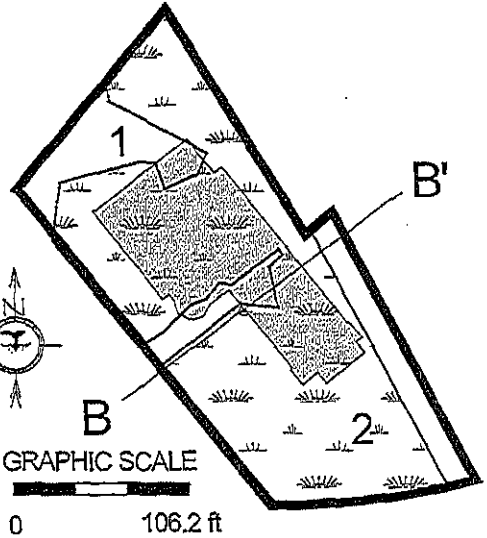

GRAPHIC SCALE
0 106.2 ft

Note:

1. Excavation will be limited to underground utility work and pole holes.
2. 150 cubic yards of native materials (including organic overburden and high silts) will be removed.
3. All excavation will take place in winter conditions.
4. Imported fill material will be sands and gravels, with a range of 5-15% passing #200 sieve.
5. 6,700 cubic yards of fill material will be used on the project area.

Horizontal Graphic Scale



Vertical Graphic Scale





- Structure
- Uplands
- PEM1/SS1B
- Property Boundary

ASRC Barrow Hotel

Applicant: Paul Kari, ASRC SKW Eskimos, Inc.
 COE File No.: POA-2011-693
 Waterway: Chukchi Sea
 Purpose: Construct ASRC Barrow Hotel
 Sec. 32 T. 23N R. 18W M. Umia
 Lat.: 71°17'52.24" Long.: 156°46'16.36"
 Sheet 5 of 6 Revised Date 01/09/2013



-  Structure
- 1  Uplands
- 2  PEM1/SS1B
-  Property Boundary

GRAPHIC SCALE

 0 266 ft

ASRC Barrow Hotel

Applicant: Paul Karl, ASRC SKW Eskimos, Inc.
 COE File No.: POA-2011-693
 Waterway: Chukchi Sea
 Purpose: Construct ASRC Barrow Hotel
 Sec. 32 T. 23N R. 18W M. Umiat
 Lat.: 71°17'52.24" Long.: 156°46'16.36"
 Sheet 6 of 6 Date 01/09/2013

TRAVIS/PETERSON ENVIRONMENTAL CONSULTING, INC.
 329 2ND STREET
 FAIRBANKS, ALASKA 99701

PROJECT NO: 1084-28

FILE: S:\Projects\1084-28\Figures\Sheet 6 of 6.SHP

DATE: 01/09/2013

SCALE: AS SHOWN